

# Z-Zero-Setter

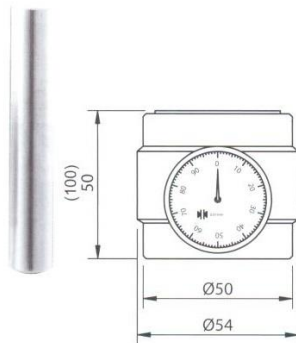

HP-50A



HP-50B

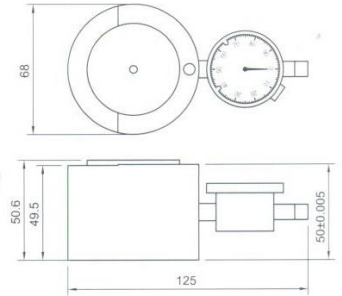

- Have the central measuring part of the zero setter presetter against a plain surface and aligned if with the outer reference surface. Turn the dial gauge for zero setting.
- Have the cutter touched against the z zero setter. Once the indicator position at zero, the distance between the tool tip to workpiece is 50mm,  $\pm 0.005$ , 100 mm,  $\pm 0.005$ .

**NEW**

ORDER NO.	H	STYLE	WEIGHT (kg)	CODE NO.
HP-50A	50mm	STANDARD TYPE	1.1	3403-020
HP-50B			1.7	3403-021
HP-50AM		WITH MAGNETIC BASE	1.2	3403-022
HP-50BM			1.7	3403-023
HP-100A	100mm	STANDARD TYPE		3403-024
HP-100AM		WITH MAGNETIC BASE		3403-025